

NORTH

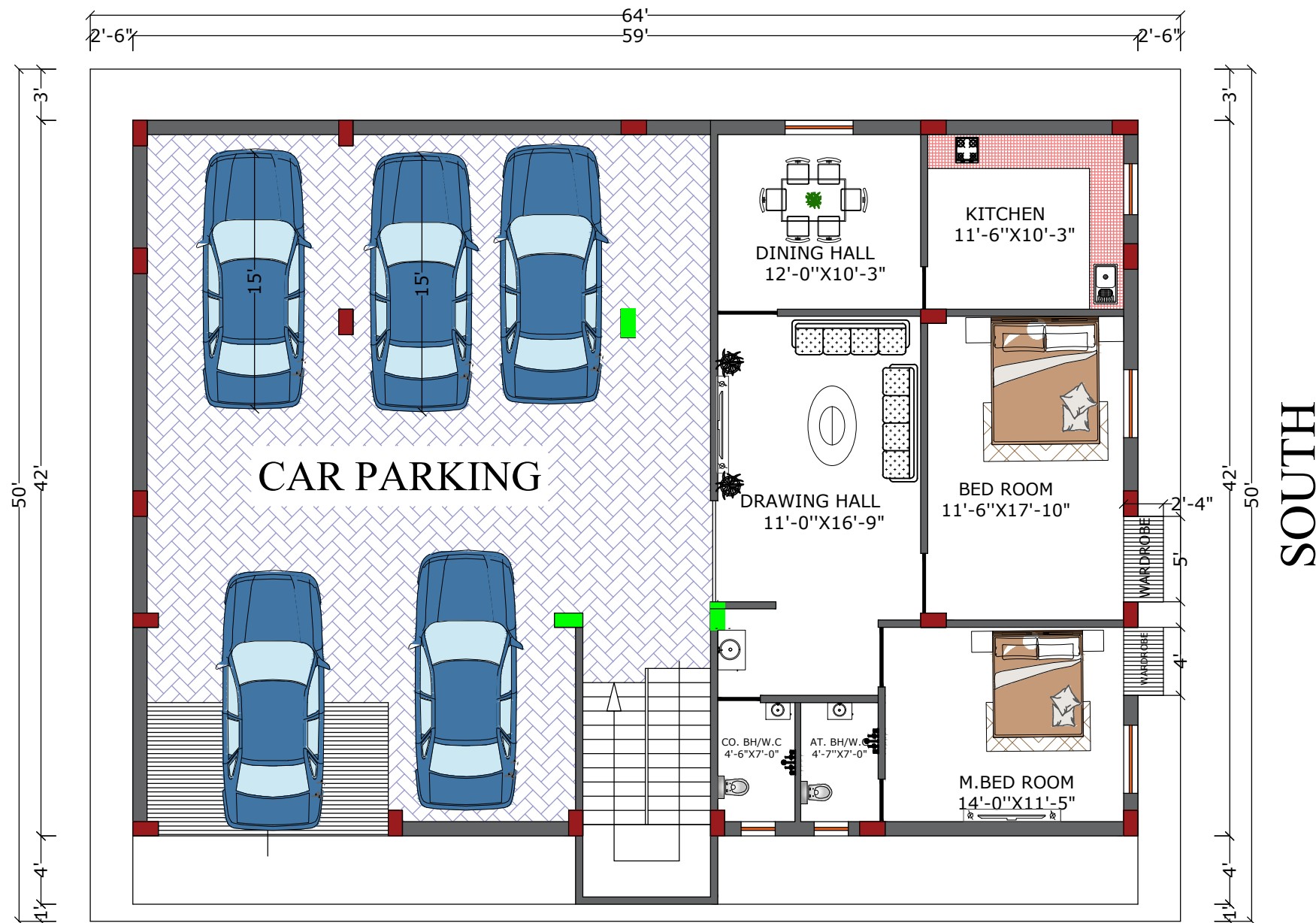

20 '-0" WIDE R O A D

WEST
GROUND FLOOR PLAN

JAYPRO INFRATECH PVT.LTD.

Our Services

Architecture Design
Structure Design
Interior Design
Estimating & Costing
Building Construction With Material

Outer Wall- 10"

Inner Wall- 05"

SCHEDULE OF DOOR & WINDOWS

	SP. L	B	H	SILL H.
D	3'-06"	-	7'-00"	3'-00"
D1	2'-06"	-	7'-00"	3'-00"
W	4'-00"	-	4'-00"	4'-00"
W1	3'-00"	-	4'-00"	4'-00"
V	2'-00"	-	1'-06"	8'-06"

Details Of Stair:-

Celling Height :- 10'

Height Of Riser:- 6.00"

Width Of Trade :- 10"

Width Of Stair :- 3'-6"

Width Of Landing :- 3'-6"

Steps Of Stair :- 20

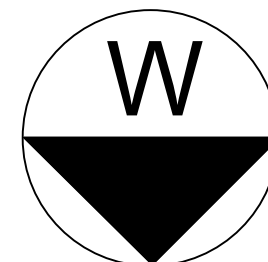

THIS DRAWING HAS NOT BEEN PUBLISHED AND IS THE SOLE PROPERTY OF
PURPOSE AS STATED IN THE AGREEMENT AND IT SHALL NOT BE REPRODUCED,
COPIED, LENT OR OTHERWISE DISPOSED OF DIRECTLY OR INDIRECTLY, NOR USED
FOR ANY OTHER PURPOSE OTHER THAN FOR WHICH IT IS FURNISHED.
ALL DIMENSIONS ARE IN MILLIMETER UNLESS OTHERWISE SPECIFIED.

CLIENT :- MR.PRATEEK SIR

PROJECT :- GROUND FLOOR PLAN

SCALE:- 1:100
Plan Number:- 01
ISSUED 09.09.25

Design By Ar. Soni Kumari

Checked By Er. Jayprakash Kumar

Approved By Jaypro Infratech Pvt.Ltd.



Jaypro Infratech Pvt.Ltd.

Office Address: 1st Floor, Pandooi
Place, Boring Road, Patna- 80001